



Powercor Australia Ltd
ABN 89 064 651 109

Agreement for the Installation of (Watchman) Security Floodlighting (Municipal Councils and Shires Only)

Please return this form to one of the Powercor offices on the attached list. For further information contact your nearest office.

Customer Name: _____
(Block Letters)

Postal Address: _____

Email Address: _____

Supply Address For
"Watchman" Light/s:

Telephone: _____
National Meter
Identification Number:
(if applicable)

Floodlight Sizes Available:

Lamp Type	Installation charge includes GST	Number Requested
LED medium output	\$ 2,597.10	
LED high output	\$ 3,115.20	

Installation Costs (excludes any Host Retailer charges for energy costs):

An **Installation Charge** will be payable for each light prior to installation. This installation charge applies to each light and excludes ongoing charges applied by the electricity Host Retailer.

In some situations Watchman lighting may not be available and you may be required to make alternative arrangements. In the event that Powercor is unable to provide a Watchman light at the location specified we will advise you.

I hereby apply for provision of Watchman Floodlighting as detailed below. I accept and agree to comply with the conditions as detailed in this Agreement.

Customer Signature: _____ Date ____ / ____ / ____

Office Use Only

Floodlights Erected and Operational on/...../.....	Installation charge of \$
Sales Order No	on/...../.....
Payment Received on/...../.....	NMI No

Conditions

- 1 The provision of the floodlighting will be subject to -
 - 1.1 The agreement of Powercor that the provision of the floodlighting will not unreasonably interfere with neighbouring properties or public roads.
 - 1.2 The availability of suitable existing Powercor low voltage reticulation poles. The poles must allow standard installation and maintenance of the floodlights without restriction. Powercor may reject the use of any pole.
 - 1.3 Under no circumstances will a new pole be provided by Powercor solely for the installation of floodlights even if the Shire/Council was willing to pay for the pole. Watchman lights will not be erected on unserviceable poles.

If the above Conditions are not satisfied, Powercor will advise the Shire/Council accordingly.

- 2 Subject to Condition 1 Powercor will provide and erect the floodlights as follows:
 - 2.1 Provision will be of the standard Powercor Watchman floodlights. No other types of lantern will be used. Powercor will retain ownership of all lanterns and associated equipment.
 - 2.2 The floodlights will be mounted with a minimum clearance above ground of 4.5 metres, in a position as agreed between the Shire/Council and Powercor Australia Ltd.
 - 2.3 Maintenance of the floodlights, including lamp replacement will be done only during normal working hours as soon as practical after a request is received by Powercor Australia Ltd.
 - 2.4 Operation of the floodlights will be controlled automatically from either existing public lighting control or by a light sensitive control switch mounted on a position as determined by Powercor Australia Ltd. There will be no variation to the normal, all night, hours of operation.
- 3 The Shire/Council will pay an Installation Charge for each floodlight prior to installation as determined by Powercor in its schedule of Network electricity prices.
- 4 The Installation Charge does not include any costs for operation or maintenance applied by the electricity Host Retailer. The Shire/Council will arrange an agreement with the electricity Host Retailer for these costs.
- 5 The floodlighting may be terminated by either the Shire/Council or Powercor giving three clear days notice in writing to the other at the address as recorded on the face of this Application, in which case Powercor may remove the floodlights.
- 6 If the Shire/Council requires a change in the type or size of floodlight, an Installation Charge will apply for each such change.
- 7 The Shire/Council shall indemnify Powercor against all loss or damage that may be caused to any third party, or to the property of any third party, by the installation, presence, operation, or non-operation of the floodlighting, unless such loss or damage shall be due to wilful misconduct on the part of Powercor or its officers.
- 8 Powercor shall not be liable for any loss or damage that may be caused to the Shire/Council or their property which may result from the total or partial failure of the floodlighting, or from the condition of the same, or from any cause whatsoever. The Shire/Council shall not be entitled to any remission of charges, if such failure should occur.
- 9 The Shire/Council shall not make attachments to, nor interfere with the floodlighting nor permit the same and shall reimburse Powercor for all costs, including overhead charges, which may be incurred by it in restoring such lighting to its original condition.
- 10 Where the floodlight is to be attached to a pole that is designed to collapse when impacted by a vehicle, Powercor shall not be liable for non-availability of service due to vehicle impact or other agencies.

Property and Installation Sketch:

To provide a timely response to your application we need to be able to accurately locate your property and determine your lighting needs.

Sketch - Please supply a detailed sketch below or attach a sketch to this form. Refer attached example.

To avoid delays and requests for more detail please check you have shown -

- property location
- aiming for light
- buildings existing & new
- north point
- distance to nearest pole
- pole number if known
- road names

Example of Sketch Details Requested

The sketch of your request should provide the detail shown in the example below. The correct information will assist Powercor to aim your light correctly.

Sketch -

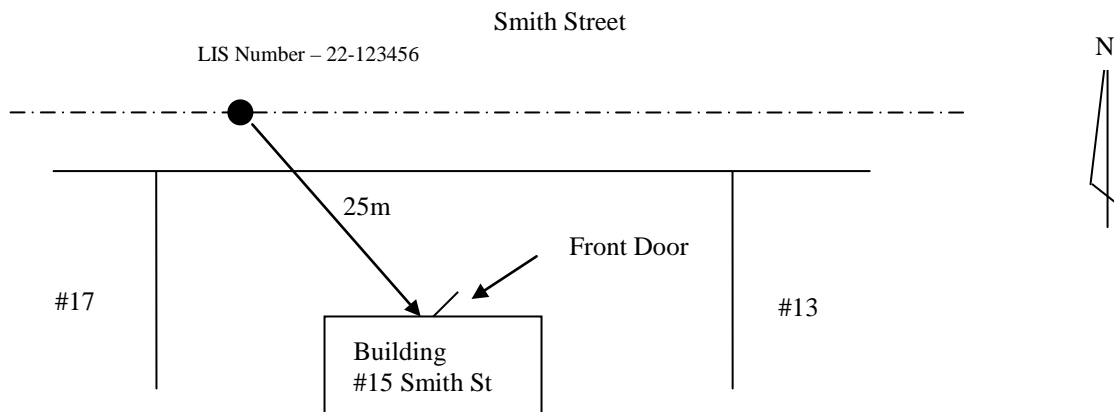

- property location
- aiming for light
- buildings existing & new
- north point
- distance to nearest pole
- pole number if known
- road names

Pole Numbers

Every Powercor pole has an individual number. This number is either made of **plastic** - black numbers on a yellow background - or a **strip of aluminium** (8mm x 50mm) with numbers stamped into it. The number is normally attached to the pole approximately 1.6 metres from ground level.

Note: On some poles there may be a round and/or square metal tag- the pole number is **NOT** on this tag.

If you require assistance to complete this form, contact your nearest Powercor Australia Office.

How to contact Powercor Australia

	Postal and Email Address	Office Location
Ardeer	Locked Bag 6 , Sunshine 3020 customerprojectsardeer@powercor.com.au	740 -742 Ballarat Rd Ardeer Telephone (03) 8363 8285 Fax: (03) 9683 5126
Ballarat	PO Box 572, Ballarat 3353 customerprojectsballarat@powercor.com.au	Norman St, Wendouree Telephone: (03) 5327 2454 Fax: (03) 5331 9139
Bendigo	Private Bag 8004, Bendigo 3550 customerprojectsbendigo@powercor.com.au	601-611 Napier St, Epsom Telephone: (03) 5440 5804 Fax: (03) 9683 5326
Geelong	PO Box 185, Geelong 3220 customerprojectsgeelong@powercor.com.au	Roseneath St, North Geelong Telephone: (03) 5240 7511 Fax: (03) 9683 5151
Mildura	PO Box 544, Mildura 3502 customerprojectsmildura@powercor.com.au	Eleventh St, Mildura Telephone: (03) 5022 5902 Fax: (03) 5449 5012
Shepparton	PO Box 6141, Shepparton 3632 customerprojectsshepparton@powercor.com.au	8-10 Wheeler St, Shepparton Telephone: (03) 5820 2601 Fax: (03) 9683 5106

Email, fax or post your completed application to one of the above offices; refer also the map below for Customer Project Advisors, Areas of Responsibility

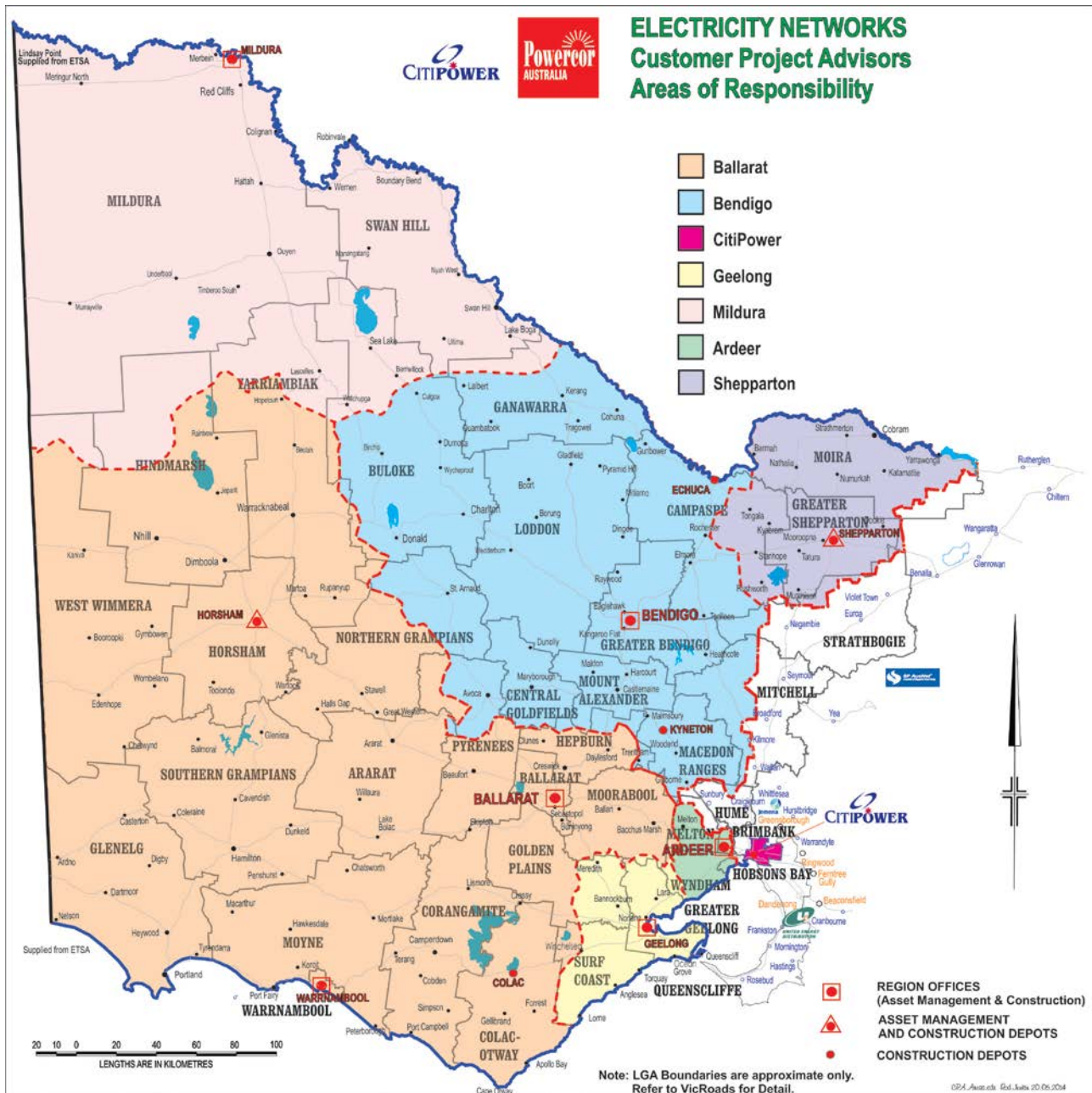

IMPORTANT NOTICE CONCERNING YOUR PRIVACY

In accordance with the Privacy Act 1998 (Commonwealth) personal information that we collect from you will be used only for the purposes of providing you with watchman floodlighting.

We may need to give the personal information that we collect from you to other participants in the electricity industry such as your electricity retailer, the Australian Energy Market Operator (AEMO), or other agents or sub-contractors who work for Powercor Australia including meter readers, etc. We will only give your personal information to other parties in order to provide you with watchman floodlighting.

If you do not provide us with the personal information that we require, we will not be able to provide you with watchman floodlighting.

You are able to obtain access to the information that we hold about you by ringing 13 22 06. A full copy of our Privacy Policy can be obtained on our Internet site at www.powercor.com.au