



# A message from Technical Standards



## CitiPower/Powercor Technical Standards Update for June 2020

Please ensure that this information is passed on to all employees and contractors with in your organisation.

The following updates are relevant to all technical, field employees and contractors undertaking design, construction and maintenance activities on the CitiPower and Powercor networks.

Technical Standards are available on our [website](#).

*All new design and construction proposals commenced after the 10 August 2020 are required to comply with these updates.*

If you have further questions, please contact the relevant team member associated with the published documents.

Standard Category	Technical Standard	Description	Overview	Impacted Key Stakeholder/s
<a href="#">D - General</a>	<a href="#">DE366-395</a>	Distribution Material Standard - D Loops, Clamps & IPC	Standard updated to include house service connector for use on LV service cables.	<b>DESIGN</b> <b>CONSTRUCTION</b> <b>MAINTENANCE</b>
<a href="#">E - Overhead</a>	<a href="#">ET061</a>	Distribution Construction Standard - LVABC Services - Cables, Connectors and Fittings	<b>Contact: Alan Su - (03) 9683 4328</b>	

<b>LEGEND</b> <b>HIGH IMPACT</b> <b>MEDIUM IMPACT</b> <b>LOW IMPACT</b>
--

# ET061 – LV ABC Services – Cables, Connectors & Fittings

## Key changes\*

Release date: 10 July 2020

*\*Please refer to official standard for details*

### What has changed?:

- Technical Standard ET061 has been updated to include a House Service Connector (figure 1) for use with LV service cables, which is able to accommodate cable sizes down to 4mm<sup>2</sup>. It is a non tension connector and therefore shall only be used within the non-tension span of the service cable.
- Material Standard DE380 has also been updated to include the connector.
- Both the Sicame and PLP products are approved for use. The two products are shown below for reference (figures 2 & 3).

### Why?:

- The current range of Pre-Insulated Non-Tension Sleeves (figure 4) do not cover all sizes of conductor, in particular below 10mm<sup>2</sup>.
- The House Service Connector, which is a range fitting, can be utilised for service cables down to 4mm<sup>2</sup>. This assists in reducing the need to disturb old style customer mains boxes with small cable sizes, when connecting to new service cables and extending service cables where necessary at the pole end.

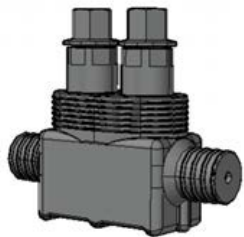

Figure 1 - House Service Connector



Figure 2 - SICAME HSC 435A



Figure 3 - PLP K96A

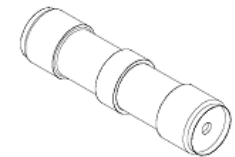

Figure 4 - Pre-insulated Non-Tension Sleeves